



一、Overview D6

The small alarm lights are waterproof , durable and high strength, made of high-quality resin. Suitable for the harsh environments.

The scientific parabolic mirror diffuses the light far away.

二、Technical spec

1. Working voltage: DC12V DC24V AC220V AC380V
2. Power frequency: 50Hz/60Hz
3. Light color: red/yellow/green/blue optional
4. Decibel level: None
6. Working mode: 1101 type general warning light, energized and rotated to emit light
7. Type of light source: light bulb
8. Police light power: 0.5W
9. Material: lampshade-PS base-ABS reflector-ABS

三、Precautions

1. When installing, check whether the power supply matches the rated voltage of the alarm
2. The warning light should face upwards during installation, using screw-fixed installation or magnetic suction
3. Make sure the wiring is accurate, and then start the power supply (DC should be distinguished between positive and negative)
4. LTE: Screw type LTD: Magnetic type
5. Product size (according to the actual product) The actual product shall prevail;

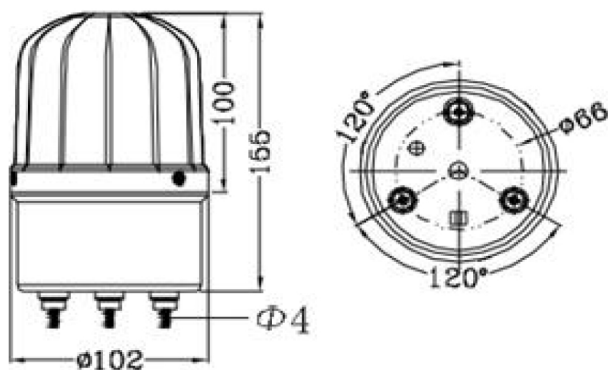

ECH